

Grooved End Connection

Series S Aluminum Bronze



- Lever Operated Ball Valve
- 1000 PSI WP
- 2" Through 4"
- Threaded Body Construction

- Enhanced Protection Against CO₂ and Saltwater Corrosion
- Multi-Seal Seats
- Fire Safe Design
- NACE Standard
- Rugged Locking Device Standard
- Maintenance Free

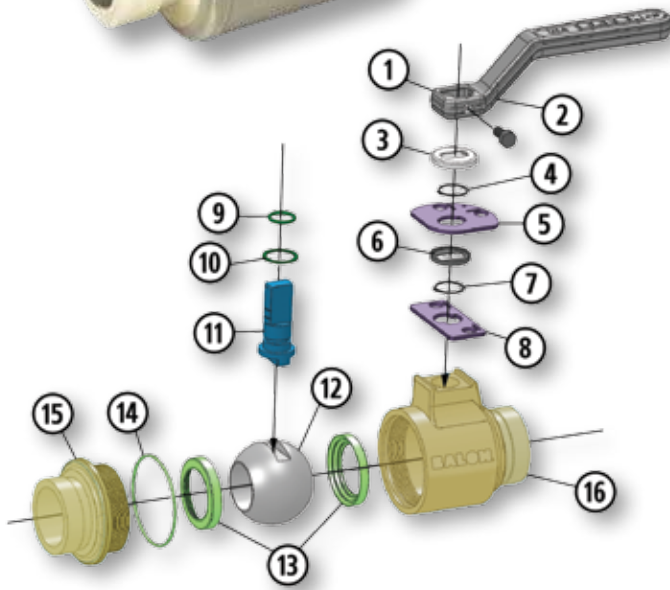

Material Description

| ITEM | PART NAME | MATERIAL NACE (STANDARD) |
|------|---------------------|---------------------------|
| 1 | Handle* | Carbon Steel/Ductile Iron |
| 2 | Handle Bolt | Standard Hex Bolt |
| 3 | Weather Guard | Polyethylene |
| 4 | Lock Plate Retainer | Stainless Steel |
| 5 | Lock Plate | Stainless Steel |
| 6 | Dust Cover | Polyethylene |
| 7 | Stop Plate Retainer | Stainless Steel |
| 8 | Stop Plate | Stainless Steel |
| 9 | Stem O-Ring | Fluorocarbon |
| 10 | Stem Seal | TFE |
| 11 | Stem | 316 Stainless Steel |
| 12 | Ball | 316 Stainless Steel |
| 13 | Ball Seat | Nylon (TFE Optional) |
| 14 | Body O-Ring | Fluorocarbon |
| 15 | End Adapter | ASTM B148-9D (955) |
| 16 | Body | ASTM B148-9D (955) |

*Handle is optional. Balon valves can also be operated with a standard open-end wrench.

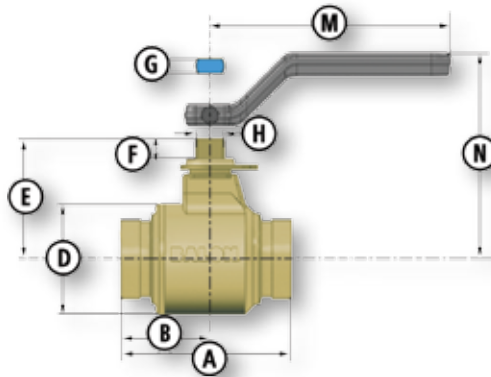

Dimensional Data

| SIZE | CATALOG NUMBER | | PORT | A | B | D | E | F | G | H | M | N | LBS. | HANDLE | Cv |
|---------|----------------|-------------|------|------|------|------|------|-----|------|-------|-------|------|------|-----------|-----|
| | NACE TRIM | BALL & STEM | | | | | | | | | | | | | |
| 2x1.5x2 | 2R-S44N-GE | 316 SS | 1.5 | 5.12 | 2.68 | 3.37 | 3.62 | .62 | .434 | .873 | 7.25 | 5.25 | 7.5 | P-4128-CS | 140 |
| 3x2x3 | 3R-S44N-GE | 316 SS | 2 | 7.25 | 3.50 | 4.50 | 4.37 | .75 | .497 | .998 | 10.25 | 6.20 | 16 | P-4129-CS | 200 |
| 4x3x4 | 4R-S44N-GE | 316 SS | 3 | 8.87 | 4.50 | 6 | 5.75 | .87 | .747 | 1.373 | 20 | 7.75 | 34 | P-4127-DI | 550 |